

## Room 1, Room 1, Lynton Road South, Gravesend DA11 7NF

Goldwyn Knight are delighted to bring to market this exceptionally refurbished ensuite room within a beautifully maintained house share on Lynton Road South, DA11. Finished to an outstanding standard throughout, this room offers a premium living experience in a peaceful, well-connected residential location.

### Key Features:

Private luxury ensuite – fully tiled with premium fittings including gold fixtures, rainfall shower, and designer flush  
Smart entry system – secure card and fob access with keyless smart lock entry to your room  
Video intercom – no unwanted interruptions from deliveries  
Wall-mounted Smart TV in room for your convenience  
Stylish contemporary décor and high-spec finishes throughout

### Shared Facilities:

Spacious kitchen/diner, shared with just 3 other rooms – ideal for social yet comfortable co-living  
Fully equipped with:  
Ample cupboard space  
Two large fridge/freezers, including a Samsung American-style fridge with filtered water and ice dispenser  
Two washer/dryers, dishwasher, and all essential appliances

- High-spec ensuite room – recently refurbished to an exceptional standard
- Private bathroom – fully tiled with luxury gold fixtures, rainfall shower & modern flush
- Smart access – card/fob & keyless smart lock entry for added security
- Wall-mounted Smart TV included in the room
- No delivery disturbances – video intercom system for peace of mind
- Spacious kitchen-diner – shared between just 4 rooms
- All bills included – gas, electric, council tax, water, superfast Wi-Fi
- Large rear garden – with cycle rack, lounge seating & rear access
- Prime residential location – quiet street, close to shops, amenities & transport
- Available Now

£900 Per month

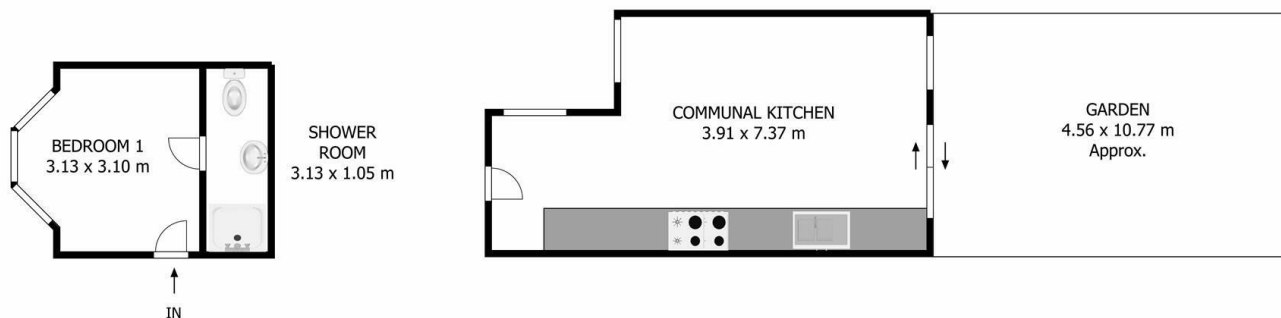

Ground Floor

Room 1  
12.86 sq m / 138.13 sq ft

Lynton Road South Gravesend DA11 7NF

This plan serves solely as a layout guide, and no liability is assumed for errors, omissions, or inaccuracies. It was developed in accordance with the RICS Code of Measuring Practice. All dimensions, including windows, doors, and the Total Gross Internal Area (GIA), are estimated and measured internally. For accurate measurements, please consult a certified architect or surveyor prior to making any decisions based on this plan.

